

HERTFORDSHIRE GARDENS TRUST

LOCAL LIST: DACORUM

Present Name of Site
BOVINGDON LODGE

Historic Name (if known)
Darley Ash (until c1700)

Parish/Town **Bovingdon**

National Grid Reference of Principal Building: TL019033

Present Area length of garden remaining to the east of the listed house approx
250 yds

Brief Description

Principal Building: C18 or earlier, enlarged in early C19. Brick faced with Roman cement. Hipped slate roof. A large rectangular 2 and 3 storeys house with its narrow end facing south to the road. The south front has 2 storeys on the left with a stringcourse and 3 windows to each floor. Sash windows recessed with blindboxes and 6/6 panes. 6 panel moulded door with rectangular fanlight and wide bracketed eaves. 3 storeys east part on right 2 windows wide and wide porch with 6 panel moulded double doors and segmental Adam fanlight. Recessed triple sash windows with small panes. French doors to the garden on the east

This is a comparatively small site and is shown on Dury and Andrews 1766 at which date there would appear to be some cultivation in the NNW. Today the land and garden are in divided ownership. On this NNW of the site there is now a detached house within what appears to be a walled enclosure and though there is some garden land to the west, the most extensive, remaining part of the garden is to the east of the listed house with lawns, trees and shrubs predominating, giving a sense of a previous ornamental garden.

Approach : Part of the original approach drive from the east as it turns north from Chipperfield Road is still in use but there are spurs off to other dwellings, all of which are lined with hedge and flanked with trees.

Important people associated with site: <i>Resident:</i> Sir James Colliton who changed the name from Darley Ash to Bovingdon Lodge c1700. (more detailed information on benefaction boards in parish church)
Assessment of significance.
Principal Uses: Residential
Public Access/Rights of Way: None
Designations: (e.g. Scheduled Ancient Monuments, Conservation Area, Listed Buildings, EH Register of Historic Parks & Gardens, Tree Preservation Orders, SSSIs, Nature Reserve, National Trust, County Wildlife Site, etc) Grade II: House Green Belt Landscape Character Area: 107, Bovingdon and Chipperfield Plateau
Sources of information: Drury & Andrews, Heritage Gateway and HALS



Ordnance Survey First Edition, 1873 Sheet XXXIII Scale: 6" to 1 mile

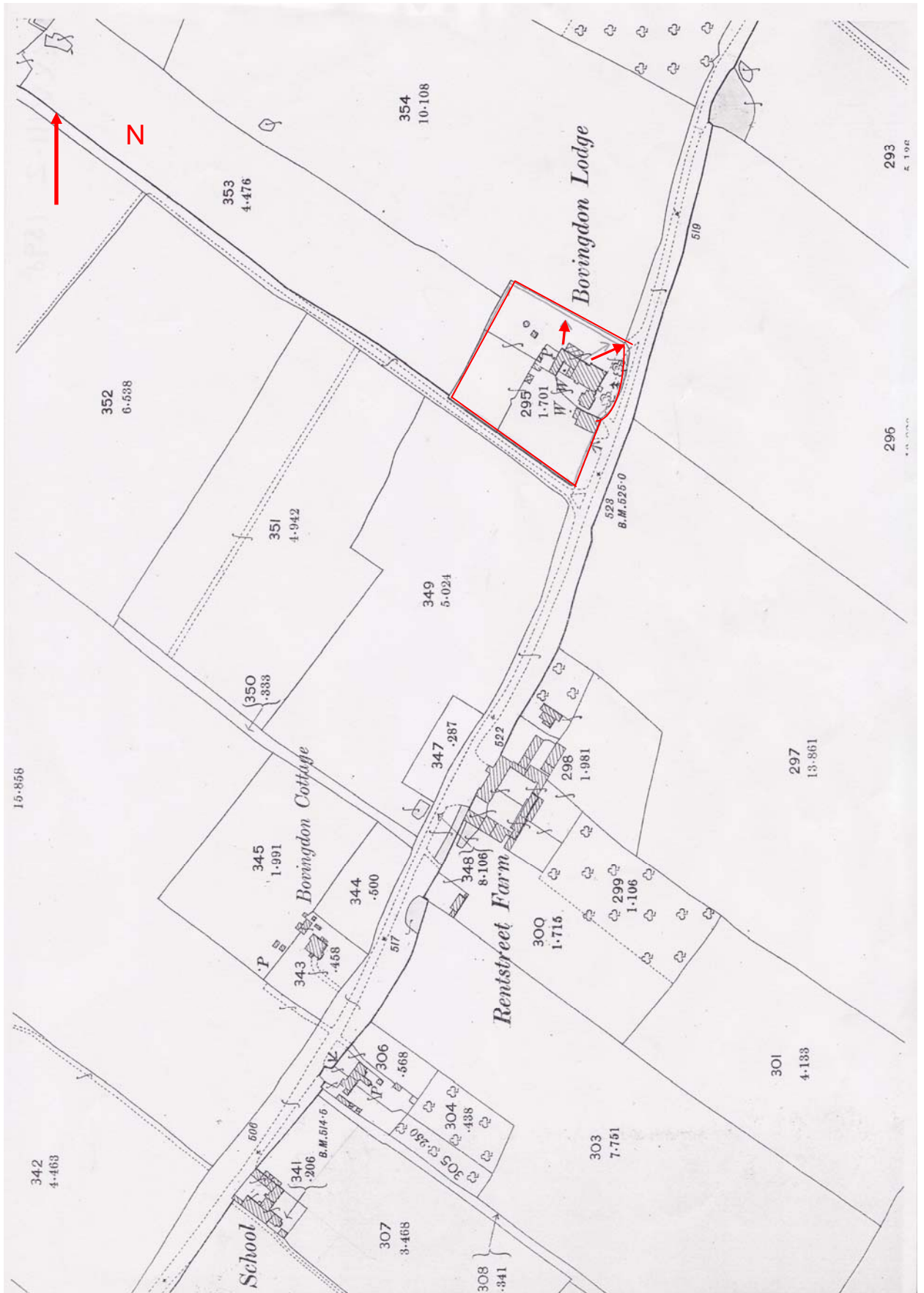

Ordnance Survey Second Edition 1898 Sheet XXXVII.2 Scale 25" to 1 Mile